

The Great Grid Upgrade

Sea Link

Sea Link

Volume 2: Plans and Drawings

Document 2.8.2: Statutory and Non Statutory Sites of Nature Conservation Geological and Landscape Importance - Kent

Planning Inspectorate Reference: EN020026

**Version: A Version 2, change request
November 2025**

**Infrastructure Planning (Applications: Prescribed Forms and Procedure)
Regulations 2009 Regulation 5(2)(I)**

nationalgrid

Page intentionally left blank

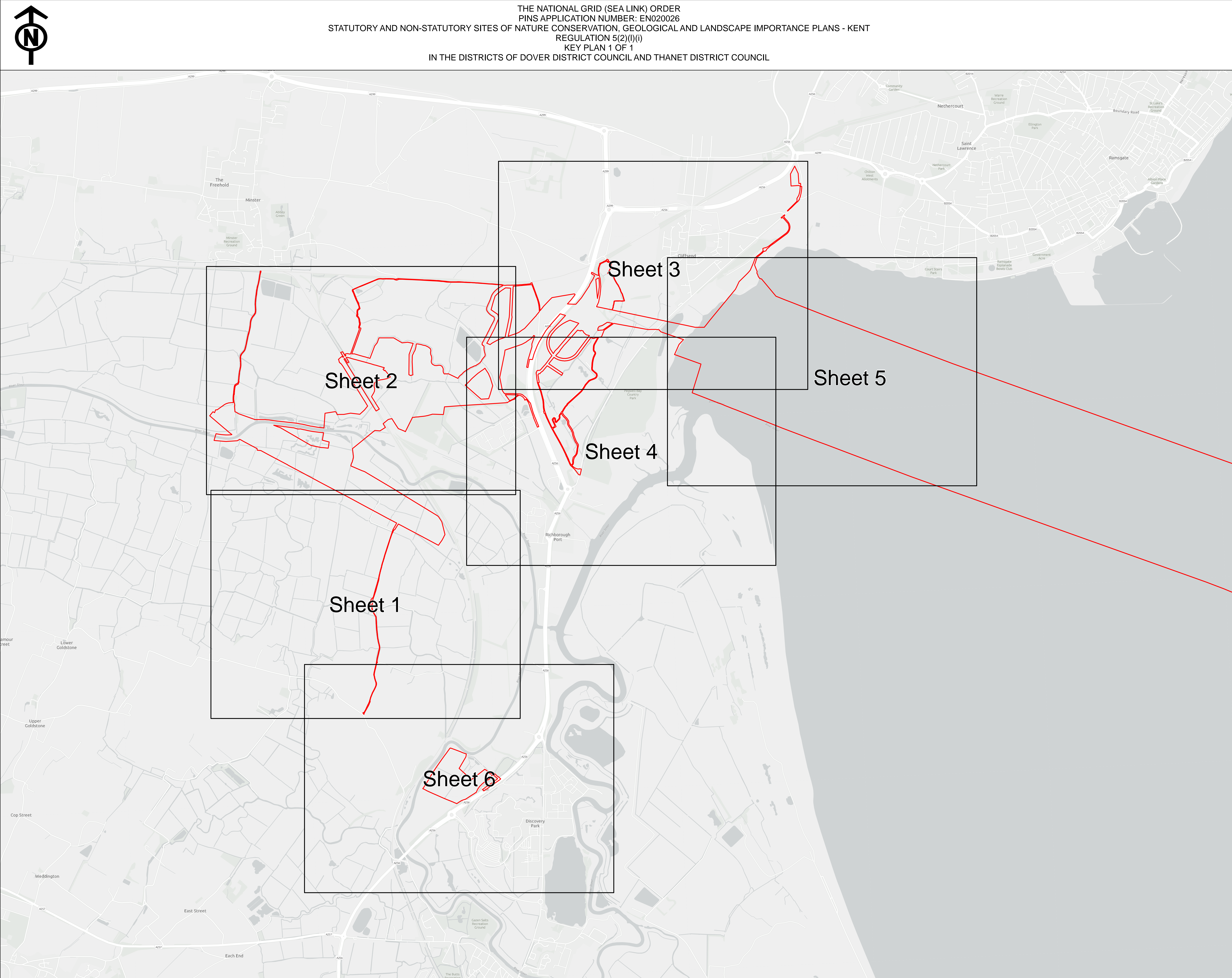

Legend

 Order Limits

 Detailed sheets

1. This plan is scaled at paper size A0, therefore any prints taken at smaller sizes will affect accuracy of the measurement units and should not be scaled against.
2. These plans show the Order Limits and potential locations for the works. Due to the need for future flexibility, National Grid will be applying for Order Limits and Limits of Deviation within its Development Consent Order, within which any final alignment would lie.
3. For further information on construction please refer to the construction section of the Environmental Statement.
4. Reference should be made to the Guide to the Plans (Document Ref 2.1) which provides further information on what the plans show.

BACKGROUND MAPPING INFORMATION HAS BEEN REPRODUCED FROM THE ORDNANCE SURVEY BY PERMISSION OF THE ORDNANCE SURVEY OF THE CONTROLLER OF HIS MAJESTY'S STATIONERY OFFICE. CROWN COPYRIGHT ORDNANCE SURVEY © 100024241. BLUESKY INTERNATIONAL LTD © NATIONAL GRID ELECTRICITY SRI COMMUNITY PANS CONTRIBUTORS. ESRI UK, ESRI, HERE, GARMIN, FOUR SQUARE, GEOTECHNOLOGIES, INC, METI/MASA, USGS NATIONAL STATISTICS LICENCED UNDER THE OPEN GOVERNMENT LICENCE V3.0

Title

THE NATIONAL GRID (SEA LINK) ORDER
PINS APPLICATION NUMBER: EN020026
STATUTORY AND NON-STATUTORY SITES OF NATURE
CONSERVATION, GEOLOGICAL AND LANDSCAPE
IMPORTANCE PLANS - KENT
REGULATION 5(2)(i)(i)
KEY PLAN 1 OF 1

Application Number	EN020026
--------------------	----------

National Grid Drawing Reference

<u>Scale</u>	<u>Sheet Size</u>	<u>Sheet</u>	<u>Issue</u>
1:10,000	A0	SHEET 1 OF 1	A ver.2

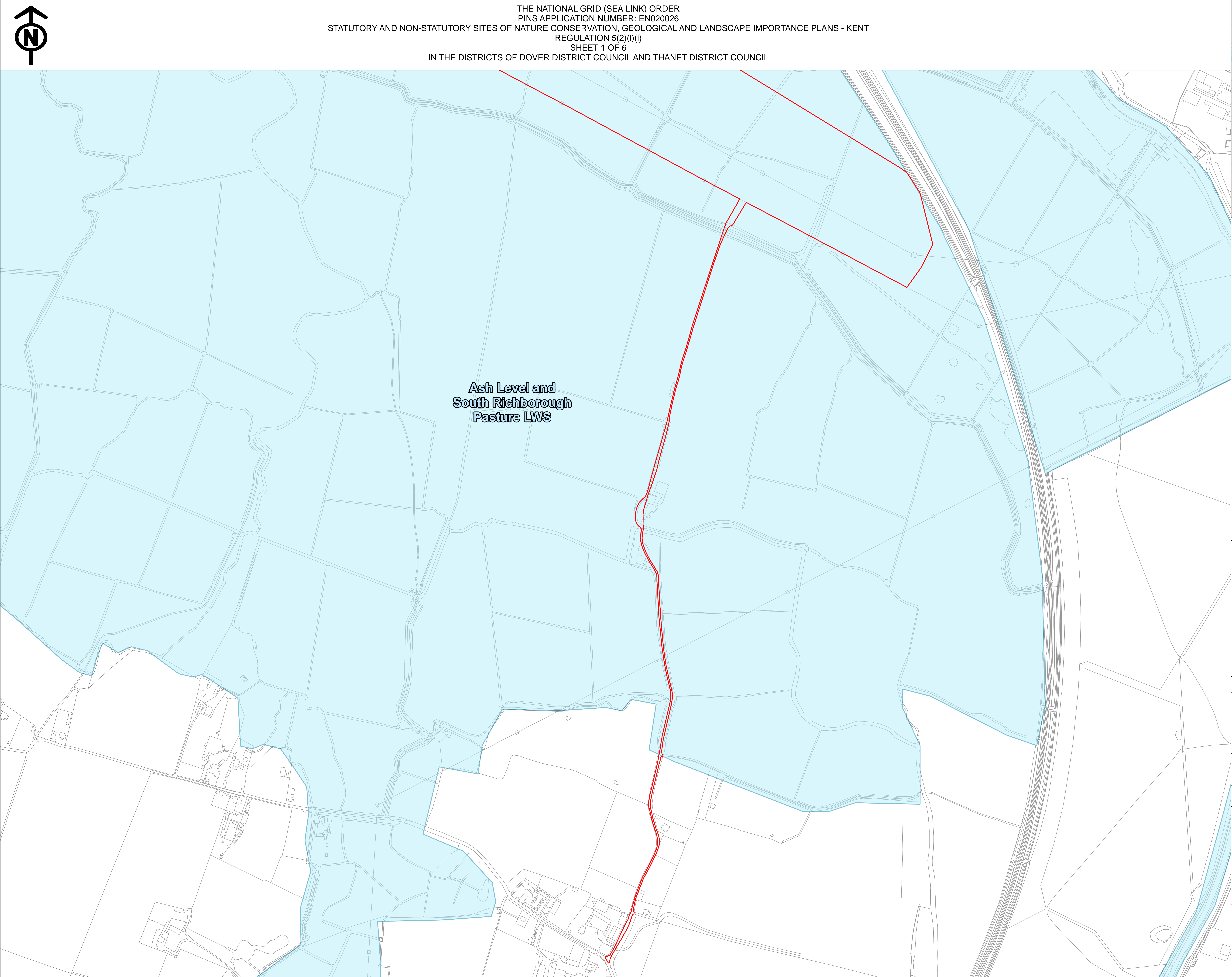

SITE MAP

1

2

3

4

6

River Stour

A26

Framlingham Great Ouse School

Framlingham Road

Framlingham

Legend



Order Limits

Local Wildlife Site (LWS)

1. This plan is scaled at paper size A0, therefore any prints taken at smaller sizes will affect accuracy of the measurement units and should not be scaled against.
2. These plans show the Order Limits and potential locations for the works. Due to the need for future flexibility, National Grid will be applying for Order Limits and Limits of Deviation within its Development Consent Order, within which any final alignment would lie.
3. For further information on construction please refer to the construction section of the Environmental Statement.
4. Reference should be made to the Guide to the Plans (Document Ref 2.1) which provides further information on what the plans show.

Title

THE NATIONAL GRID (SEA LINK) ORDER
PINS APPLICATION NUMBER: EN020026
STATUTORY AND NON-STATUTORY SITES OF NATURE
CONSERVATION, GEOLOGICAL AND LANDSCAPE
IMPORTANCE PLANS - KENT
REGULATION 5(2)(I)(I)
SHEET 1 OF 6

Application Number

National Grid Drawing Reference

DCO/K/NCGL/PS/0708

<u>Scale</u>	<u>Sheet Size</u>	<u>Sheet</u>	<u>Issue</u>
1:2,500	A0	SHEET 1 OF 6	A

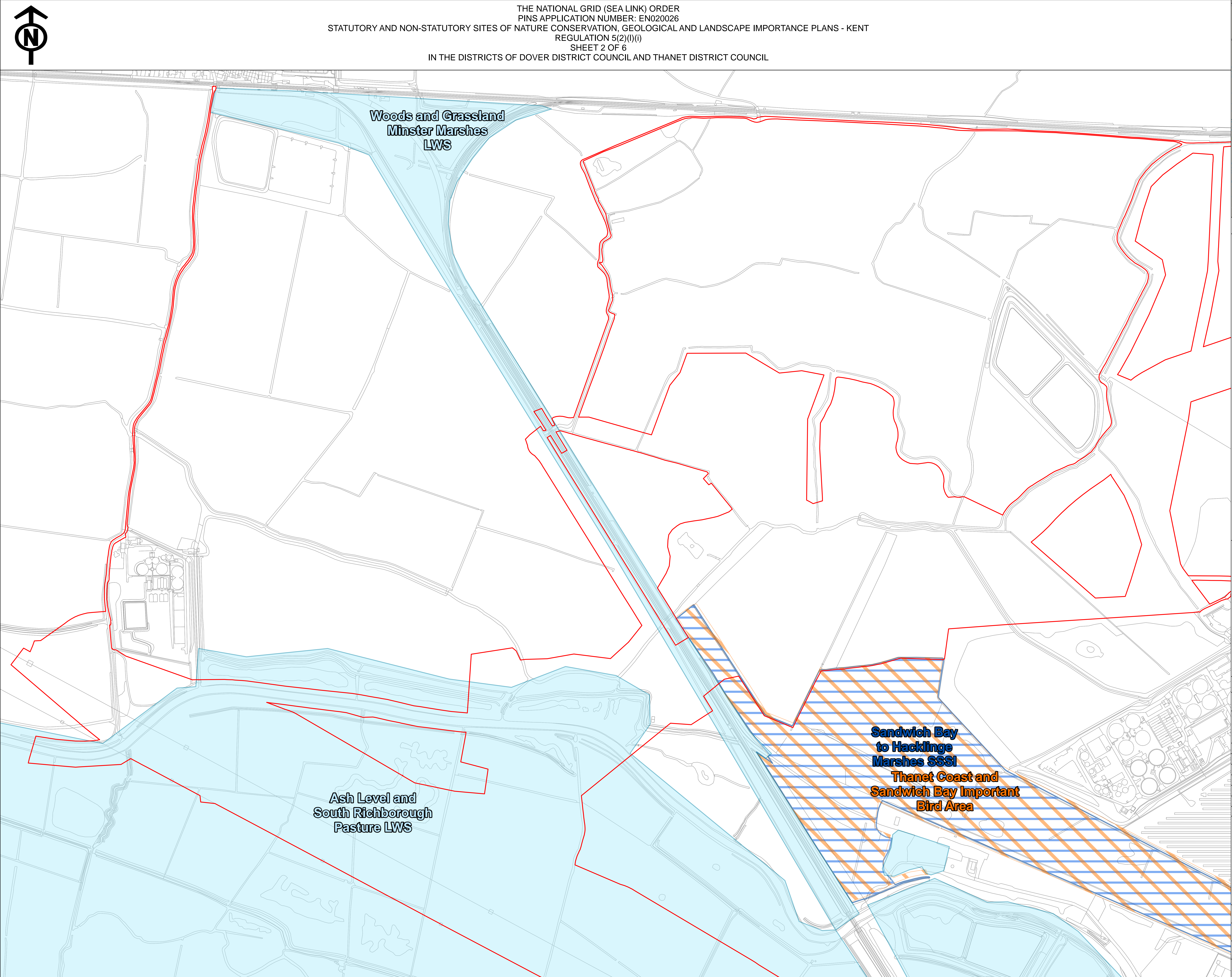

SITE MAP

Application document 2.8.2

Legend

Order Limits

Site of Special Scientific Interest (SSSI)

Important Bird Area

Local Wildlife Site (LWS)

Notes

1. This plan is scaled at paper size A0, therefore any prints taken at smaller sizes will affect accuracy of the measurement units and should not be scaled against.
2. These plans show the Order Limits and potential locations for the works. Due to the need for future flexibility, National Grid will be applying for Order Limits and Limits of Deviation within its Development Consent Order, within which any final alignment would lie.
3. For further information on construction please refer to the construction section of the Environmental Statement.
4. Reference should be made to the Guide to the Plans (Document Ref 2.1) which provides further information on what the plans show.

Coordinate System: British National Grid
Sheet X Centroid Coordinate: 631861.9375 Sheet Y Centroid Coordinate: 163171.65625

0 62.5 125 250 500 750 1000 1250 1500 1750 2000 2250 2500 2750 3000 3250 3500 3750 4000 4250 4500 4750 5000 5250 5500 5750 6000 6250 6500 6750 7000 7250 7500 7750 8000 8250 8500 8750 9000 9250 9500 9750 10000

Metres

BACKGROUND MAPPING INFORMATION HAS BEEN REPRODUCED FROM THE ORDNANCE SURVEY BY PERMISSION OF ORDNANCE SURVEY OF THE CONTROLLER OF HIS MAJESTY'S STATIONERY OFFICE. CROWN COPYRIGHT ORDNANCE SURVEY © 1900/2024. BLUEBERRY INTERNATIONAL LTD IS NATIONAL GRID ELECTRICITY ESR COMMUNITY MAPS CONTRIBUTORS: ESR UK, ESR, HERE, GARMAN, FOUR SQUARE, GOSPELMOCKS, INC, METRACAL, USGS. OFFICE FOR NATIONAL STATISTICS LICENCED UNDER THE OPEN GOVERNMENT LICENCE V3.0

A	06/03/25	For Submission	JF	SC	JW
Issue	Date	Remarks	Drawn	Checked	Approved
<p>Title</p> <p>THE NATIONAL GRID (SEA LINK) ORDER PINS APPLICATION NUMBER: EN020026 STATUTORY AND NON-STATUTORY SITES OF NATURE CONSERVATION, GEOLOGICAL AND LANDSCAPE IMPORTANCE PLANS - KENT REGULATION 5(2)(I)(I) SHEET 2 OF 6</p>					

Application Number

EN020026

National Grid Drawing Reference

DOCK/NCGL/PS/0709

Scale	Sheet Size	Sheet	Issue
1:2,500	A0	SHEET 2 OF 6	A

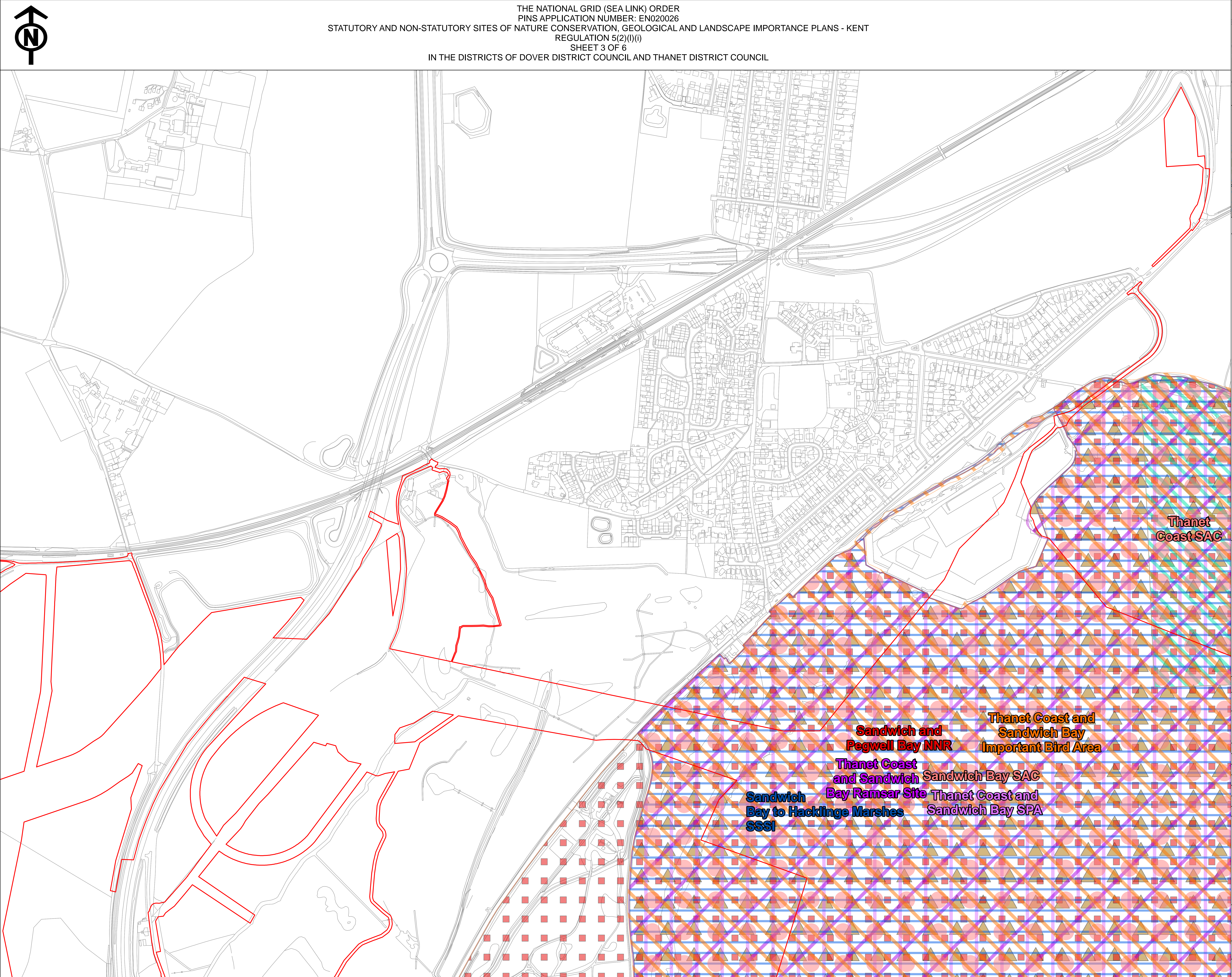

Notes

1. This plan is scaled at paper size A0, therefore any prints taken at smaller sizes will affect accuracy of the measurement units and should not be scaled against.
2. The plans show the Order Limits and potential locations for the works. Due to the need for future flexibility, National Grid will be applying for Order Limits and Limits of Deviation within its Development Consent Order, within which any final alignment would lie.
3. For further information on construction please refer to the construction section of the Environmental Statement.
4. Reference should be made to the Guide to the Plans (Document Ref 2.1) which provides further information on what the plans show.

Coordinate System: British National Grid
Sheet X Centroid Coordinate: 634300.375 Sheet Y Centroid Coordinate: 164087.64062



BACKGROUND MAPPING INFORMATION HAS BEEN REPRODUCED
FROM THE ORDINANCE SURVEY BY PERMISSION OF ORDINANCE
SURVEY OF THE CONTROLLER OF HIS MAJESTY'S STATIONERY
OFFICE. CROWN COPYRIGHT ORDINANCE SURVEY © 100020241.
BLUESKY INTERNATIONAL LTD © NATIONAL GRID ELECTRICITY
ESRI COMMUNITY MAPS CONTRIBUTORS: ESRI UK, ESRI, HERE, GARMIN,
FOUR SQUARE, GEOTECHNOLOGIES, INC, METINASA, USGS
OFFICE FOR NATIONAL STATISTICS LICENCED UNDER THE OPEN GOVERNMENT LICENCE V3.0

A ver.2	Nov 25	Change request version	JF	SC	JW
A	06/03/25	For Submission	JF	SC	JW
Issue	Date	Remarks	Drawn	Checked	Approved

Title

THE NATIONAL GRID (SEA LINK) ORDER
PINS APPLICATION NUMBER: EN020026
STATUTORY AND NON-STATUTORY SITES OF NATURE
CONSERVATION, GEOLOGICAL AND LANDSCAPE
IMPORTANCE PLANS - KENT
REGULATION 5(2)(l)(i)
SHEET 5 OF 6

nationalgrid

<u>Application Number</u>			
EN020026			
<u>National Grid Drawing Reference</u>			
DCO/K/NCGL/PS/0710			
<u>Scale</u>	<u>Sheet Size</u>	<u>Sheet</u>	<u>Issue</u>
1:2,500	A0	SHEET 3 OF 6	A ver.2

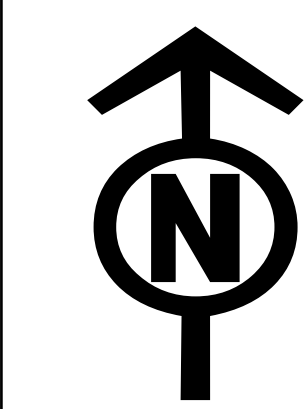

THE NATIONAL GRID (SEA LINK) ORDER
PINS APPLICATION NUMBER: EN020026
STATUTORY AND NON-STATUTORY SITES OF NATURE CONSERVATION, GEOLOGICAL AND LANDSCAPE IMPORTANCE PLANS - KENT
REGULATION 5(2)(I)(i)
SHEET 4 OF 6
IN THE DISTRICTS OF DOVER DISTRICT COUNCIL AND THANET DISTRICT COUNCIL

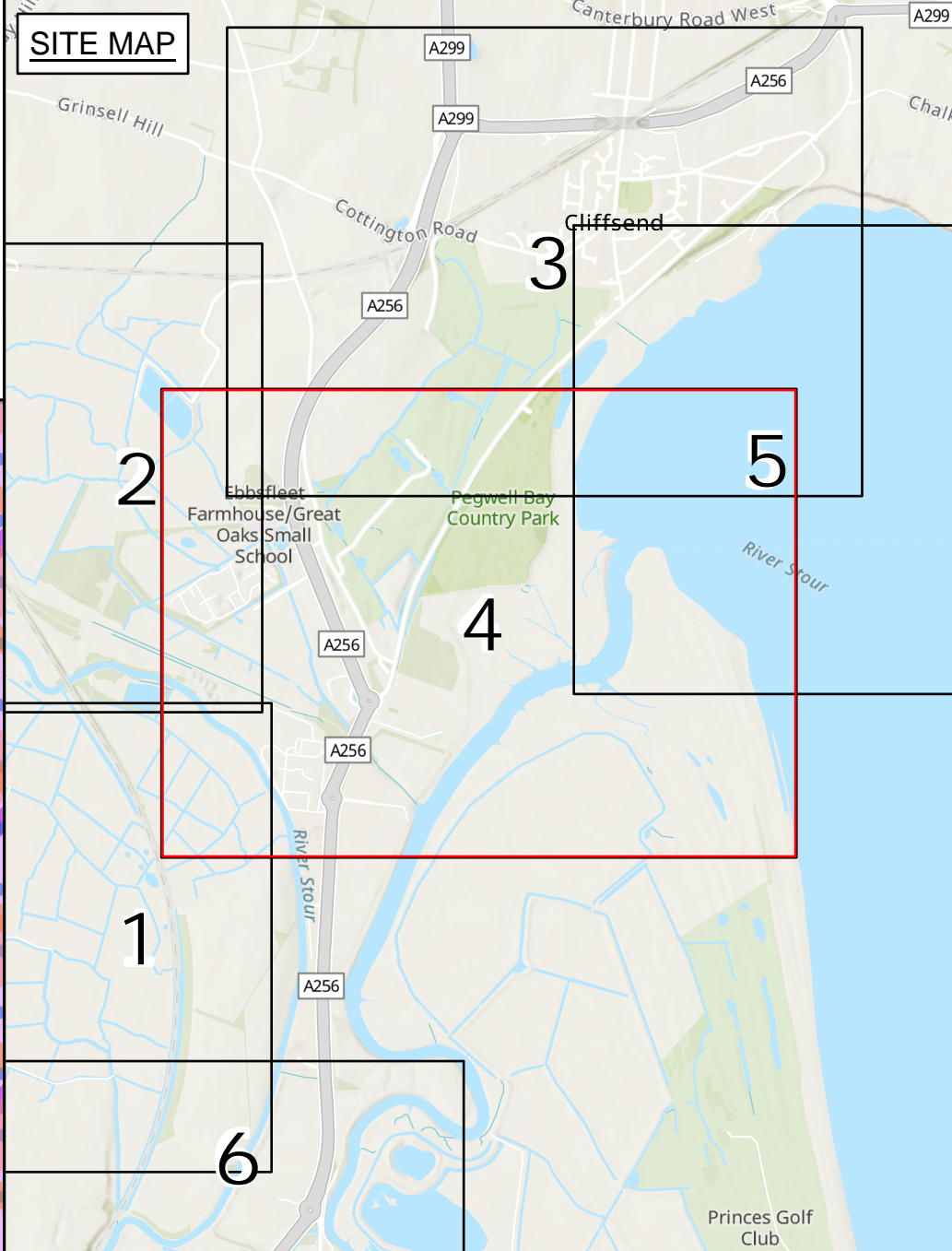
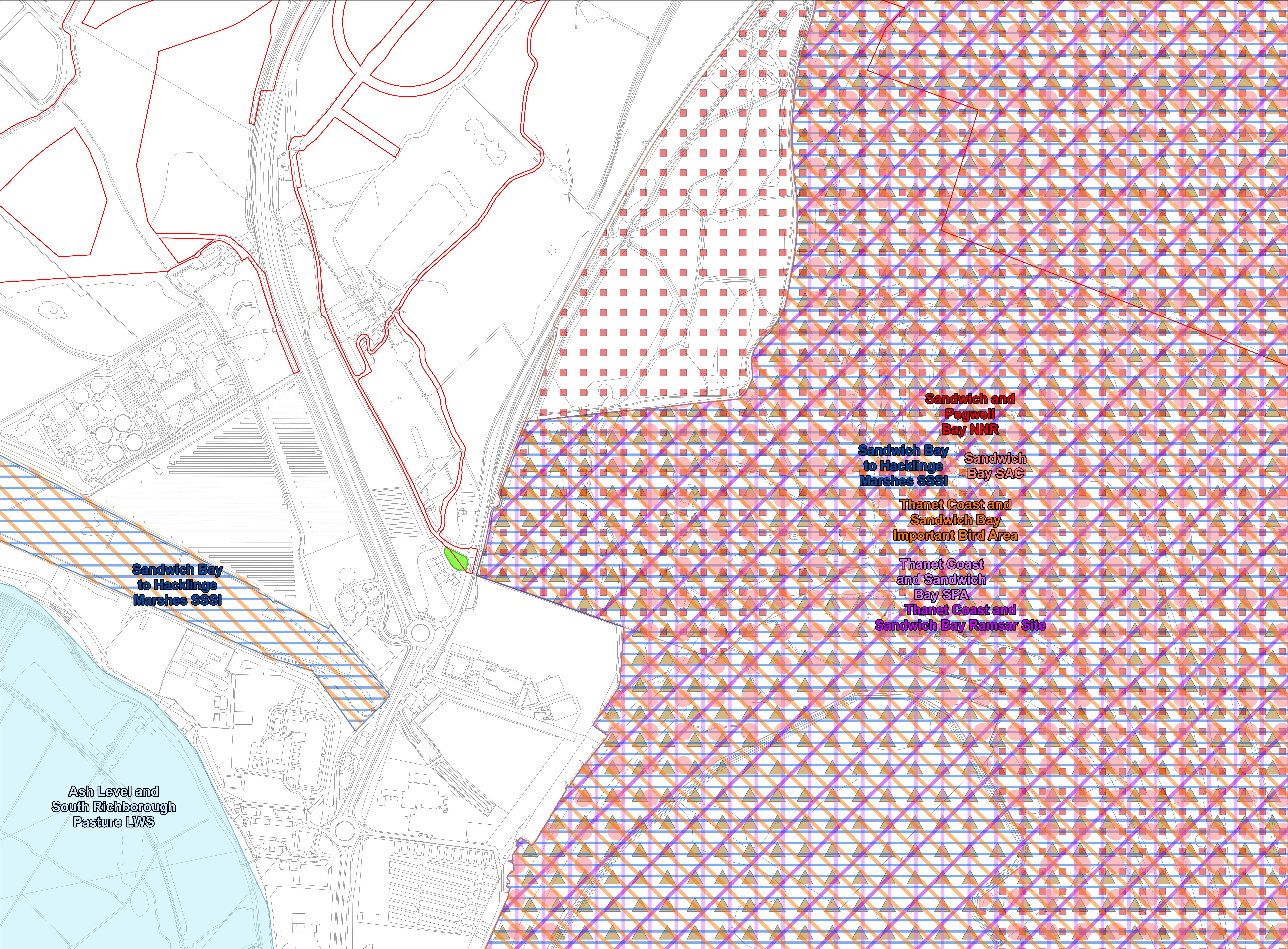

Application document 2.8.2

Legend	
	Order Limits
	Site of Special Scientific Interest (SSSI)
	Important Bird Area
	National Nature Reserve (NNR)
	Ramsar Site
	Special Area of Conservation (SAC)
	Special Protection Area (SPA)
	SPA with Marine Component
	Tree Preservation Order (TPO) area
	Local Wildlife Site (LWS)

Notes
1. This plan is scaled at paper size A0, therefore any prints taken at smaller sizes will affect accuracy of the measurement units and should not be scaled against.
2. These plans show the Order Limits and potential locations for the works. Due to the need for future flexibility, National Grid will be applying for Order Limits and Limits of Deviation within its Development Consent Order, within which any final alignment would lie.
3. For further information on construction please refer to the construction section of the Environmental Statement.
4. Reference should be made to the Guide to the Plans (Document Ref 2.1) which provides further information on what the plans show.

Coordinate System: British National Grid
Sheet X Centroid Coordinate: 634385.75 Sheet Y Centroid Coordinate: 161481.59376
0 62.5 125 250 Metres
BACKGROUND MAPPING INFORMATION HAS BEEN REPRODUCED FROM THE ORDNANCE SURVEY BY PERMISSION OF ORDNANCE SURVEY OF THE CONTROLLER OF HIS MAJESTY'S STATIONERY OFFICE. CROWN COPYRIGHT ORDNANCE SURVEY © 10002491. INTERPOLATED NATIONAL GRID ELECTRICITY HULLS. ESR COMMUNITY MAPS CONTRIBUTORS: ESR UK, ESR, HERE, GARMAN, PONSLOW, GOTTSCHEW, JONES, WILKINS, LWS. OFFICE FOR NATIONAL STATISTICS LICENCED UNDER THE OPEN GOVERNMENT LICENCE V3.0

A	06/03/25	For Submission	JF	SC	JW
Issue	Date	Remarks	Drawn	Checked	Approved

Title
THE NATIONAL GRID (SEA LINK) ORDER
PINS APPLICATION NUMBER: EN020026
STATUTORY AND NON-STATUTORY SITES OF NATURE CONSERVATION, GEOLOGICAL AND LANDSCAPE IMPORTANCE PLANS - KENT
REGULATION 5(2)(I)(i)
SHEET 4 OF 6



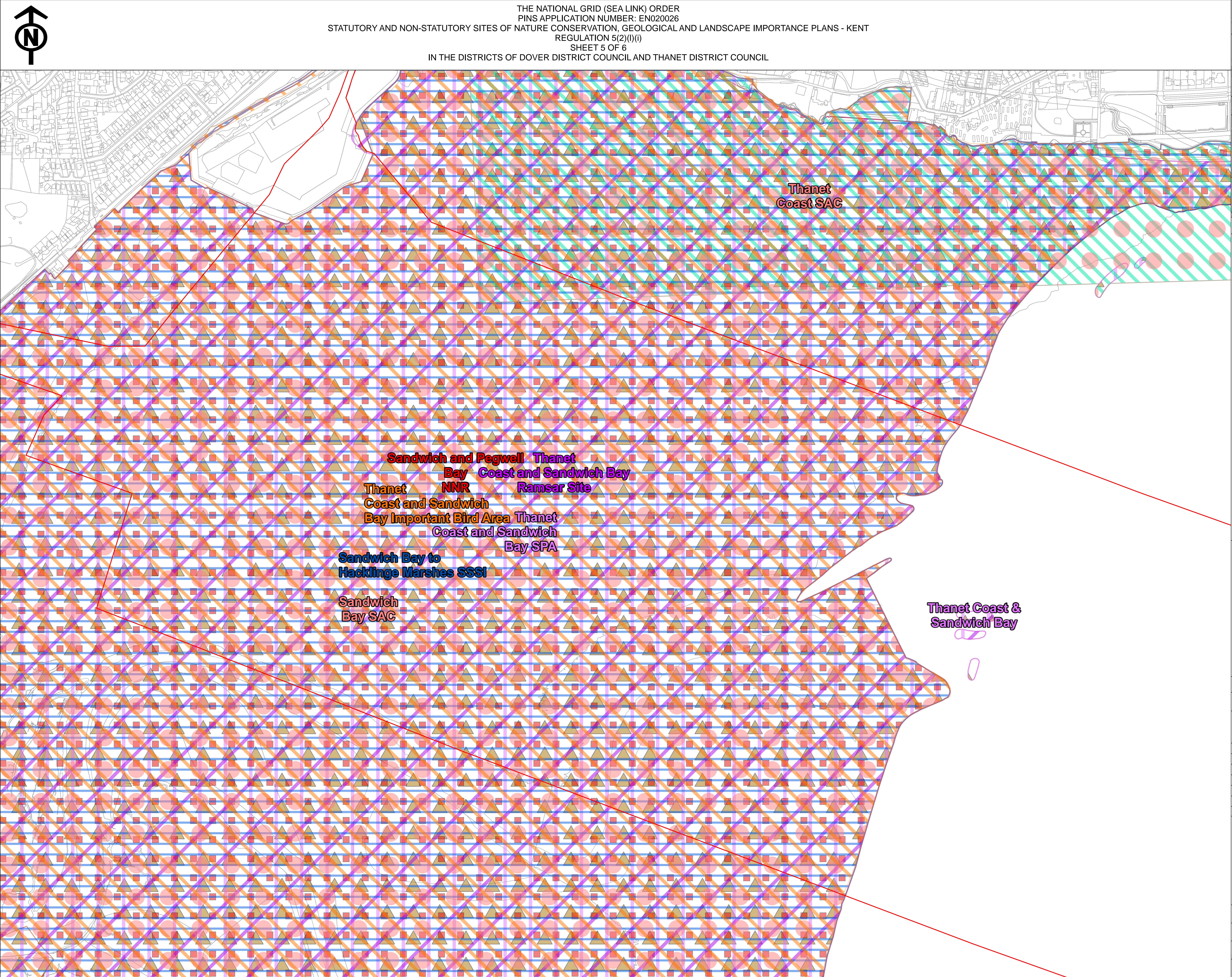

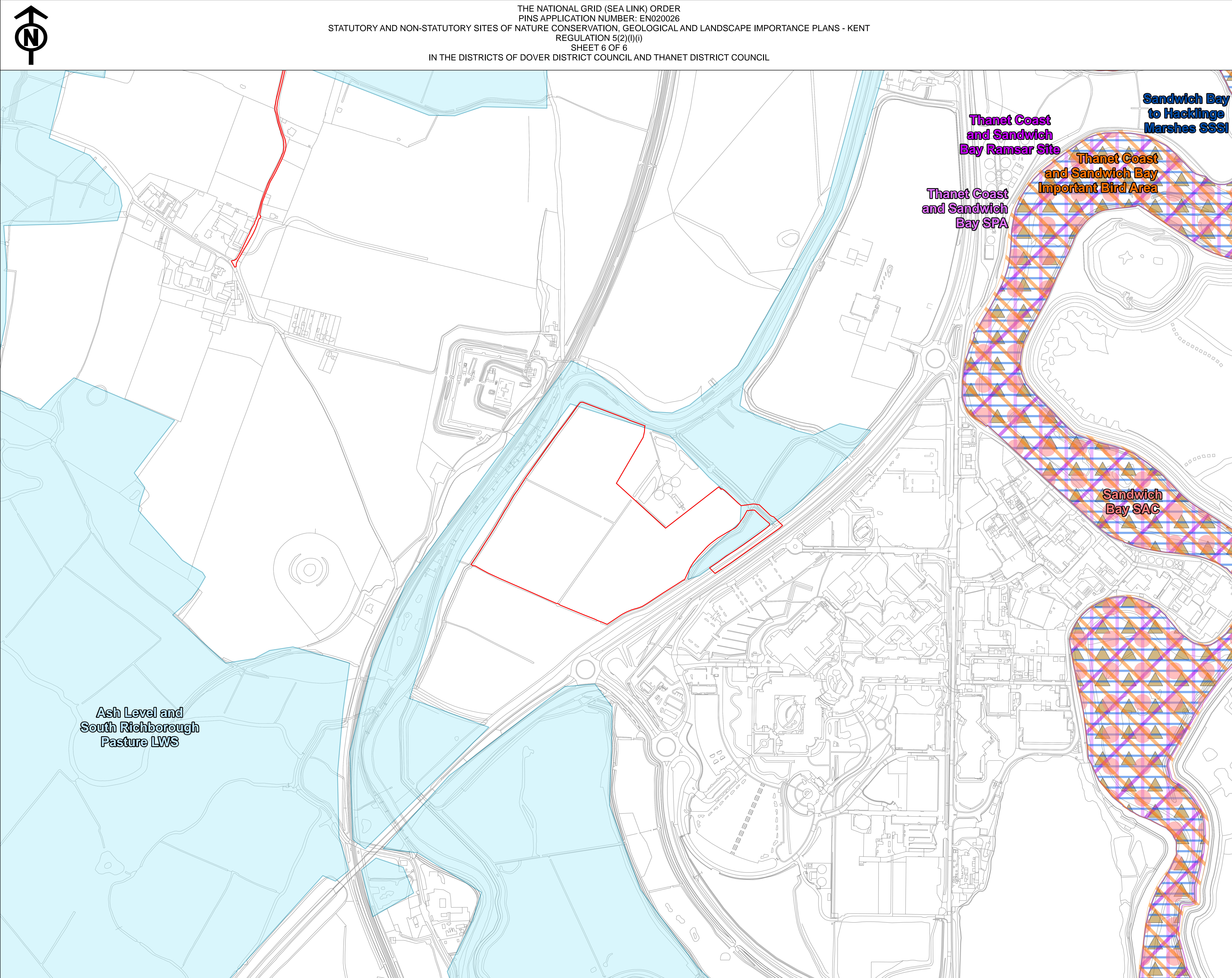



nationalgrid			
Application Number		EN020026	
National Grid Drawing Reference		DCO/K/NCGL/PS/0711	
Scale	Sheet Size	Sheet	Issue
1:2,500	A0	SHEET 4 OF 6	A

[illegible]



COPYRIGHT: NOT TO BE REPRODUCED WITHOUT THE WRITTEN PERMISSION OF NATIONAL GRID ELECTRICITY TRANSMISSION PLC



	Order Limits
	Site of Special Scientific Interest (SSSI)
	Important Bird Area
	Ramsar Site
	Special Area of Conservation (SAC)
	Special Protection Area (SPA)
	SPA with Marine Component
	Local Wildlife Site (LWS)

1. This plan is scaled at paper size A0, therefore any prints taken at smaller sizes will affect accuracy of the measurement units and should not be scaled against.
2. These plans show the Order Limits and potential locations for the works. Due to the need for future flexibility, National Grid will be applying for Order Limits and Limits of Deviation within its Development Consent Order, within which any final alignment would lie.
3. For further information on construction please refer to the construction section of the Environmental Statement.
4. Reference should be made to the Guide to the Plans (Document Ref 2.1) which provides further information on what the plans show.

Coordinate System: British National Grid
Sheet X Centroid Coordinate: 632687.625 Sheet Y Centroid Coordinate: 159095.46875

0 62.5 125 250
Metres

BACKGROUND MAPPING INFORMATION HAS BEEN REPRODUCED FROM THE ORDNANCE SURVEY BY PERMISSION OF ORDNANCE SURVEY OF THE UNITED KINGDOM OF GREAT BRITAIN AND NORTHERN IRELAND. ORDNANCE SURVEY OFFICE CROWN COPYRIGHT ORDNANCE SURVEY © - 100020421.

BLUESKY INTERNATIONAL LTD. NATIONAL GRID ELECTRICITY SUPPLY DATA © 2008. ALL RIGHTS RESERVED. ESRI COMMUNITY MAP CONTRIBUTORS. ESRI UK. ESRI HERE. GARDINER, POLYGRAPH, GEOTECHNOLOGIES, INC. METNAGIA LOGS.

OFFICE FOR NATIONAL STATISTICS LICENCED UNDER THE OPEN GOVERNMENT LICENCE V3.0

A	06/03/25	For Submission	JF	SC	JW
Issue	Date	Remarks	Drawn	Checked	Approved

Title

THE NATIONAL GRID (SEA LINK) ORDER
PINS APPLICATION NUMBER: EN020026
STATUTORY AND NON-STATUTORY SITES OF NATURE
CONSERVATION, GEOLOGICAL AND LANDSCAPE
IMPORTANCE PLANS - KENT
REGULATION 5(2)(l)(i)
SHEET 6 OF 6

nationalgrid

<u>Application Number</u>			
EN020026			
<u>National Grid Drawing Reference</u>			
DCO/K/NCGL/PS/0713			
<u>Scale</u>	<u>Sheet Size</u>	<u>Sheet</u>	<u>Issue</u>
1:2,500	A0	SHEET 6 OF 6	A